

- USED FOR MOUNTING CABLES OR PIPES ON FLAT SURFACES
- PROVIDES CLEARANCE BETWEEN THE CABLE/PIPE AND THE MOUNTING SURFACE
- CAN BE SUPPLIED IN A STANDARD BLACK POLYPROPYLENE (B) OR A GREY FLAME RETARDANT POLYPROPYLENE (FR)
- DETAILED DRAWINGS CAN BE SUPPLIED ON REQUEST

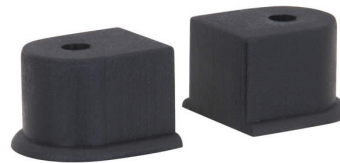

SADDLE CLIP SPACER - SEE*

PART NO.	MATERIAL SUFFIX	CABLE Ø (mm)	FIXING HOLES (mm)	PACK QTY.	WEIGHT (g)
90-M095	B or FR	9.5	3.75	500	1.8
90-M120	B or FR	12.0	3.75	500	2.4
90-01	B or FR	12.7	3.75	500	2.2
90-02	B or FR	15.0	3.75	500	2.4
90-03	B or FR	17.5	4.0	500	3.3
90-075	B or FR	19.0	4.0	500	3.6
90-04	B or FR	23.0	4.0	500	3.2
90-04.1	B or FR	24.2	4.0	500	3.1
90-05	B or FR	25.4	4.0	500	4.3
90-06	B or FR	27.5	5.0	500	5.3
90-07	B or FR	31.7	5.0	200	6.8
90-08	B or FR	34.0	5.0	200	6.7
90-09	B or FR	38.1	5.0	100	6.8
90-10	B or FR	42.0	5.0	200	8.7
90-11	B or FR	42.6	5.0	200	9.5
90-12	B or FR	44.4	5.0	100	7.4
90-13	B or FR	48.7	5.0	200	10.4
90-14	B or FR	53.9	5.0	100	14.4
90-143	B or FR	55.0	6.0	100	26.3
90-15	B or FR	60.5	6.0	100	25.8
90-19	B or FR	75.0	7.5	50	40.8
90-24++	B	88.9	10.0	25	70.7
90-S	B	Saddle Clip Spacer*			1.2

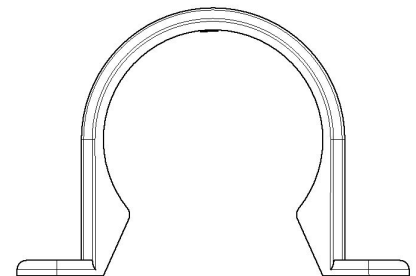
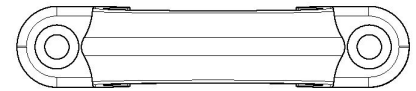

++ This item is supplied with a base plate.

* Spacer suitable for use with all saddle clips (except part no 90-24).

Provides additional separation of the cable or pipe from the mounting surface of approximately 12.5mm.