

SINGLE WAY HEAVY DUTY RADIUSED POLE CLEAT

Manufactured as standard in Black Polypropylene (B). A curved robust cleat used for securing power cables on 200mm diameter wooden electricity supply poles. Detailed drawings can be supplied on request.

PART NO.	MATERIAL SUFFIX	CABLE ϕ (mm)	FIXING HOLES (mm)	PACK QTY.	WEIGHT (g)
35-04	B	27.6	8	100	13.0
35-06	B	31.2	8	100	12.0
35-065	B	33.5	8	100	18.5
35-07	B	36.0	8	100	14.0
35-08	B	37.8	8	100	16.0
35-10	B	41.5	8	100	26.0
35-12	B	44.6	8	100	25.0
35-22	B	49.2	8	100	23.0
35-26	B	53.5	8	50	25.0
35-30	B	56.6	8	50	27.0
35-34	B	61.6	11	50	53.0
35-42	B	72.5	11	25	84.0

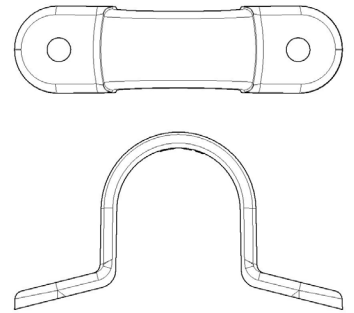

TWO WAY HEAVY DUTY RADIUSED POLE CLEAT

Manufactured as standard in Black Polypropylene (B). A curved robust cleat used for securing two power cables on 200mm diameter wooden electricity supply poles. Detailed drawings can be supplied on request.

PART NO.	MATERIAL SUFFIX	CABLE ϕ (mm)	FIXING HOLES (mm)	PACK QTY.	WEIGHT (g)
2WP04	B	11.7	4	100	6.1
2WP06	B	13.2	4	100	5.4
2WP10	B	16.5	4	100	6.5
2WP15	B	19.1	8	100	7.3

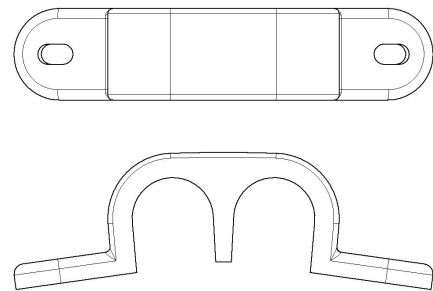

THREE WAY HEAVY DUTY RADIUSED POLE CLEAT

Manufactured as standard in Black Polypropylene (B). A curved robust cleat used for securing three power cables on 200mm diameter wooden electricity supply poles. Detailed drawings can be supplied on request.

PART NO.	MATERIAL SUFFIX	CABLE ϕ (mm)	FIXING HOLES (mm)	PACK QTY.	WEIGHT (g)
3WP04	B	11.7	6.35	200	8.0
3WP06	B	13.2	6.35	200	8.2
3WP10	B	16.5	6.35	200	9.8
3WP15	B	19.2	6.35	200	12.5
3WP20	B	21.7	6.35	200	13.7
3WP2	B	15.0	6.35	200	10.7
3WN05	B	24.0	6.35	200	11.9

